

STANDARD INCLUSIONS :

- Distribution board per floors.
- Metal clad external doors.
- Aluminum framed windows with fly screen.
- Reverse cycle air conditioner.
- Cooking & preparation facilities.
- Large fridge/freezer.
- Pot & dish wash areas.
- Kitchen equipments & Dishwasher.
- Hot water boiler & system.
- Diffused LED batten light.

STANDARD FINISHES :

Exterior:

- Steel chassis.
- Steel frame walls & ceiling.
- Trimdeck or Similar roof cladding.
- Startclad 'S' lock or similar cladding to external walls.
- R2.0 glasswool batts.
- Standard corner flashing.

Interior:

- Pre-finished poly ply lining to internal wall & ceiling.
- Commercial grade vinyl.
- PVC scotia cornice & skirting.

9000

12000

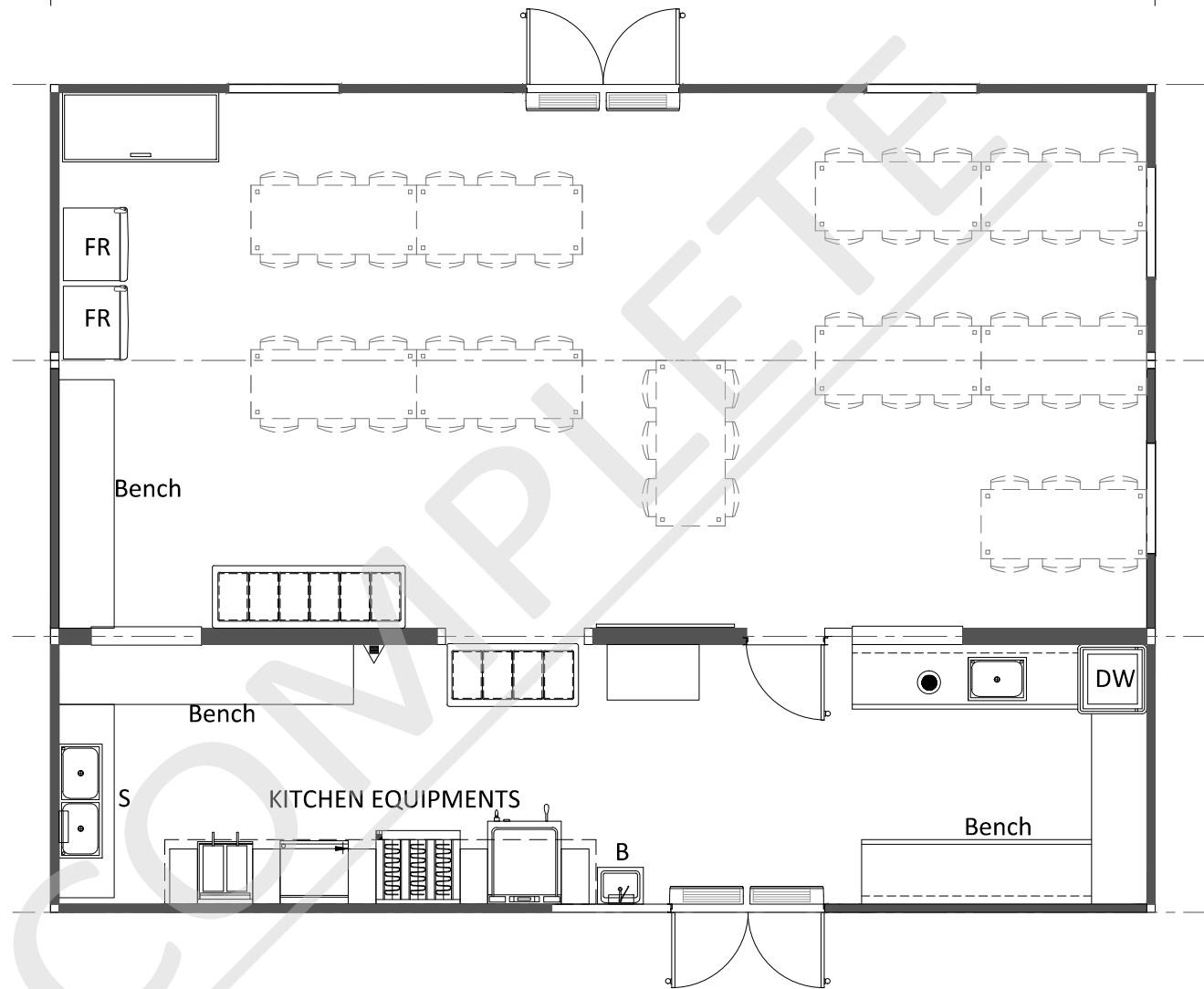

 FLOOR PLAN

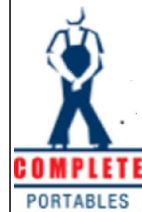

**COMPLETE
PORTABLES**

82 POWER AVENUE,
WATTLEUP, WA
(PHONE) 9410 7100

CLIENT:
COMPLETE PORTABLES
LOCATION:
HIRE FLEET - TYPICAL DRAWING

TITLE:
12.0 x 9.0 KITCHEN

DRAWING NUMBER	CATEGORY	REVISION
TYPKIT-01	KIT	A